



Compressor
Voltage Code : FZ

AE2430Z-FZ3C

Low Temp. Commercial (BP)

220 - 240V 1~ 50 Hz

R452A / R404A / R448A / R449A

AE2430Z-FZ3C

Conditions	Frequency	Nominal Cooling Capacity		Sound Power ISO3745 / ISO 3743-1
		Watts	BTU/h	
EN12900 / R452A	50 Hz	393	1339	57 dBA
EN12900 / R404A	50 Hz	422	1438	57 dBA
EN12900 / R448A	50 Hz	353	1203	57 dBA
EN12900 / R449A	50 Hz	352	1200	57 dBA

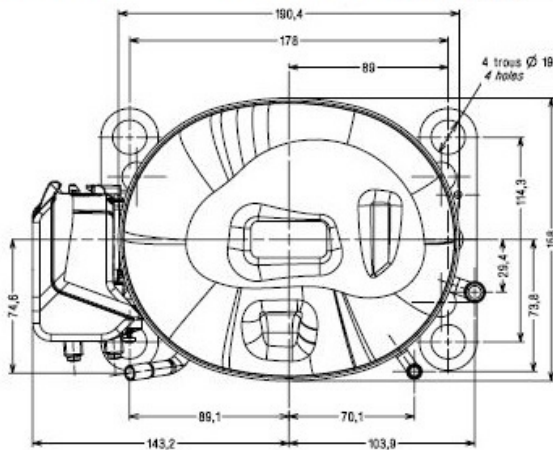
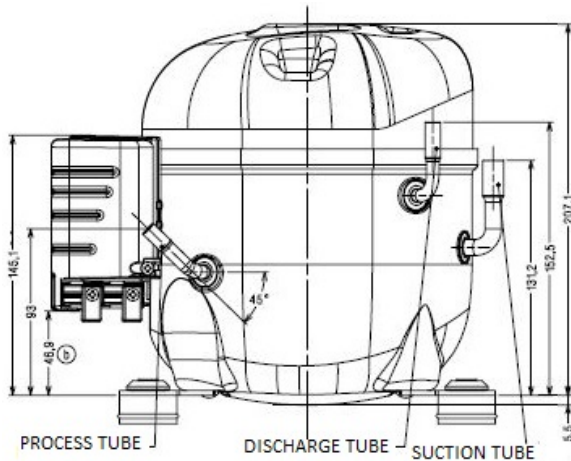

* EN12900 : T°Cond. 40.0°C / T°Evap. -35.0°C / T°Return gas temp.. 20.0°C
T°Subcooling. 0.0K

Certificates :



Displacement (cc)	14,51
Net Weight (Kg)	11.5
Oil Quantity (cc)	380.0
Oil Type	Polyolester
Expansion Device	Capillary_Tube or Expansion_Val
Cooling	Fan
Main Winding (Ohm)	3.37
Start Winding (Ohm)	11.99
Current	
RLA (A)	3.5
MCC (A)	5,1
LRA (A)	21.5
Electrical Equipment	CSR
Overload	MSP36AMW
Time Check	6.5s - 16s / 12,4 A
Open Temp	135°C
Close Temp	61°C
Start Capacitor	88-108 µf / 330 V
Run Capacitor	10 µF / 400 V
Potential Relay	RVA60**
Pick Up	277/305V
Drop Out	60/135V
Refrigerating connection for	
Suction Tube	9.5 (3/8")
Discharge Tube	6.35 (1/4")
Process Tube	6.35 (1/4")

Note : Tecumseh reserves the right to change information contained in this document without notification.

Selection program - V4.6_2023296 - 11/23/2023



Tecumseh

AE2430Z-FZ3C	Tension FZ : 220 - 240V 1~ 50 Hz
---------------------	---

Les performances sont données dans les **conditions EN12900** :
 Condition Mid

The performance data are in **EN12900 conditions** :
 Mid Condition

Gaz aspirés : 20.0 °C
 Sous refroidissement : 0.0 K

Return gas : 20.0 °C
 Subcooling : 0.0 K

© 2023 Tecumseh Products Company
 All rights reserved

50 Hz R452A

N°3476

4 T condensation	5 T évaporation	(°C)	-40	-35	-30	-25	-20	-15	-10
30	1 P frigorifique	(Watt)	344	476	629	808	1019	1266	1554
	2 P absorbée	(W)	336	384	439	498	559	619	677
	3 I absorbée	(A)	2.07	2.25	2.45	2.67	2.91	3.17	3.43
40	1 P frigorifique	(Watt)	279	393	523	674	852	1062	1309
	2 P absorbée	(W)	347	396	452	511	572	634	693
	3 I absorbée	(A)	2.12	2.30	2.50	2.73	2.98	3.25	3.52
50	1 P frigorifique	(Watt)		310	419	545	694	869	1077
	2 P absorbée	(W)		406	465	527	591	656	718
	3 I absorbée	(A)		2.33	2.54	2.78	3.05	3.33	3.62
60	1 P frigorifique	(Watt)				414	535	679	850
	2 P absorbée	(W)				535	605	674	741
	3 I absorbée	(A)				2.83	3.11	3.41	3.73

50 Hz R404A

N°3310

4 T condensation	5 T évaporation	(°C)	-40	-35	-30	-25	-20	-15	-10
30	1 P frigorifique	(Watt)	371	509	666	845	1053	1295	1576
	2 P absorbée	(W)	354	400	451	508	571	637	708
	3 I absorbée	(A)	2.21	2.35	2.53	2.74	2.99	3.27	3.58
40	1 P frigorifique	(Watt)	304	422	554	706	882	1087	1325
	2 P absorbée	(W)	365	414	469	530	595	665	740
	3 I absorbée	(A)	2.26	2.43	2.62	2.85	3.12	3.42	3.77
50	1 P frigorifique	(Watt)		336	446	572	719	889	1087
	2 P absorbée	(W)		426	487	555	627	704	785
	3 I absorbée	(A)		2.46	2.69	2.95	3.25	3.59	3.97
60	1 P frigorifique	(Watt)			336	438	555	691	848
	2 P absorbée	(W)			495	572	655	741	832
	3 I absorbée	(A)			2.73	3.03	3.37	3.76	4.18

1 = cooling capacity 2 = power input 3 = current 4 = condensing temperature 5 = evaporating temperature

Nota : Tecumseh se réserve le droit de modifier les informations contenues dans ce document sans préavis.

Note : Tecumseh reserves the right to change information contained in this document without notification.



Tecumseh

AE2430Z-FZ3C	Tension FZ : 220 - 240V 1~ 50 Hz
---------------------	---

Les performances sont données dans les conditions EN12900 :	Gaz aspirés :	20.0 °C
Condition Mid	Sous refroidissement :	0.0 K
The performance data are in EN12900 conditions :	Return gas :	20.0 °C
Mid Condition	Subcooling :	0.0 K

50 Hz R448A (*)								
N°3477								
4 T condensation	5 T évaporation	(°C)	-35	-30	-25	-20	-15	-10
30	1 P frigorifique	(Watt)	430	583	765	980	1235	1533
	2 P absorbée	(W)	366	417	473	535	601	673
	3 I absorbée	(A)	2.12	2.31	2.53	2.78	3.07	3.41
40	1 P frigorifique	(Watt)	353	484	640	825	1044	1304
	2 P absorbée	(W)	379	434	494	558	627	700
	3 I absorbée	(A)	2.18	2.39	2.63	2.90	3.21	3.55
50	1 P frigorifique	(Watt)	282	395	528	686	874	1099
	2 P absorbée	(W)	386	449	517	588	663	741
	3 I absorbée	(A)	2.19	2.44	2.72	3.02	3.36	3.74
60	1 P frigorifique	(Watt)			427	562	723	915
	2 P absorbée	(W)			529	610	695	783
	3 I absorbée	(A)			2.78	3.13	3.52	3.94

50 Hz R449A (*)								
N°3478								
4 T condensation	5 T évaporation	(°C)	-35	-30	-25	-20	-15	-10
30	1 P frigorifique	(Watt)	428	582	763	979	1233	1531
	2 P absorbée	(W)	365	416	473	534	600	672
	3 I absorbée	(A)	2.12	2.30	2.52	2.78	3.07	3.40
40	1 P frigorifique	(Watt)	352	483	638	823	1042	1302
	2 P absorbée	(W)	378	434	494	558	626	699
	3 I absorbée	(A)	2.18	2.39	2.63	2.90	3.20	3.55
50	1 P frigorifique	(Watt)	281	394	526	684	873	1096
	2 P absorbée	(W)	385	449	516	587	662	740
	3 I absorbée	(A)	2.19	2.44	2.72	3.02	3.36	3.73
60	1 P frigorifique	(Watt)			426	560	721	913
	2 P absorbée	(W)			528	610	695	782
	3 I absorbée	(A)			2.78	3.13	3.51	3.93

1 = cooling capacity 2 = power input 3 = current 4 = condensing temperature 5 = evaporating temperature

(*) Veuillez vous référer strictement aux Recommandations d'Utilisation et Bulletins Marketing Tecumseh du fait de la température de reflux élevée pour les applications LBP.
 (*) Due to very high discharge temperature especially on LBP conditions, please strictly refer to Tecumseh Guidelines & Marketing Bulletin when using this refrigerant.

Nota : Tecumseh se réserve le droit de modifier les informations contenues dans ce document sans préavis.

Note : Tecumseh reserves the right to change information contained in this document without notification.

© 2023 Tecumseh Products Company
All rights reserved