



Compressor  
Voltage Code : FZ

**AJ2446P-FZ**

Low Temp. Commercial (BP)

220 - 240V 1~ 50 Hz

R452A / R404A / R455A / R454C

**AJ2446P-FZ3A**

Conditions	Frequency	Nominal Cooling Capacity		Sound Power ISO3745 / ISO 3743-1
		Watts	BTU/h	
Standard TE / R452A	50 Hz	1133	3864	57 dBA
Standard TE / R404A	50 Hz	1213	4137	57 dBA
Standard TE / R455A	50 Hz	1074	3663	57 dBA
Standard TE / R454C	50 Hz	969	3304	57 dBA

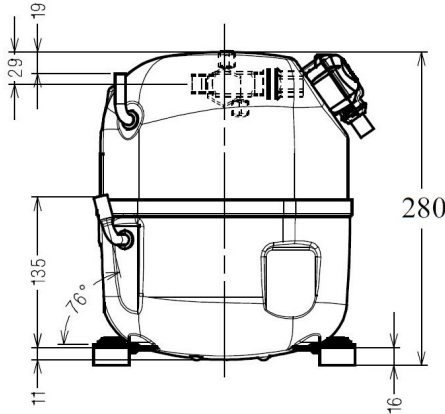

<b>Displacement (cc)</b>	26,2
<b>Net Weight (Kg)</b>	21.5
<b>Oil Quantity (cc)</b>	475.0
<b>Oil Type</b>	Polyolester
<b>Expansion Device</b>	Capillary_Tube/Expansion_Valve
<b>Cooling</b>	Fan
<b>Main Winding (Ohm)</b>	2.9
<b>Start Winding (Ohm)</b>	8.8
<b>Current</b>	
RLA (A)	3,9
MCC (A)	8,2
LRA (A)	29,5
<b>Electrical Equipment</b>	CSR
<b>Overload</b>	MST18AIN
Time Check	7,5s - 14s / 20,7 A
Open Temp	120° C
Close Temp	69° C
Optional	T0750
<b>Start Capacitor</b>	88 µF / 330 V
<b>Run Capacitor</b>	15 µF / 400 V
<b>Potential Relay</b>	RVA40**
Pick Up	280/310V
Drop Out	60/121V
<b>Refrigerating connection for</b>	
Suction Tube	15.9 (5/8")
Discharge Tube	7.9 (5/16")
Process Tube	6.35 (1/4")

\* Standard TE : T°Cond. 54.5°C / T°Evap. -23.3°C / T°Return gas temp.. 32.0°C  
T°Subcooling. 19.7K

Certificates :



Note : Tecumseh reserves the right to change information contained in this document without notification.

Selection program - V4.6\_2023296 - 10/25/2023



**Tecumseh**

<b>AJ2446P-FZ</b>	<b>Tension FZ : 220 - 240V 1~ 50 Hz</b>
-------------------	---

Les performances sont données dans les **conditions Standard TE** :  
 Condition Mid

The performance data are in **Standard TE conditions** :  
 Mid Condition

Gaz aspirés : 32.0 °C  
 Sous refroidissement : 21.0 K

Return gas : 32.0 °C  
 Subcooling : 21.0 K

© 2023 Tecumseh Products Company  
 All rights reserved

**50 Hz R452A**

**N°3604**

4   T condensation	5   T évaporation	(°C)	-40	-35	-30	-25	-20	-15	-10
<b>30</b>	1   P frigorifique	(Watt)	559	788	1063	1392	1780	2235	2762
	2   P absorbée	(W)	496	580	664	750	837	926	1017
	3   I absorbée	(A)	2.32	2.64	2.99	3.38	3.80	4.26	4.76
<b>40</b>	1   P frigorifique	(Watt)		687	954	1272	1649	2092	2608
	2   P absorbée	(W)		576	679	785	892	1003	1118
	3   I absorbée	(A)		2.64	3.08	3.54	4.04	4.57	5.14
<b>50</b>	1   P frigorifique	(Watt)			823	1125	1485	1912	2414
	2   P absorbée	(W)			677	802	930	1063	1201
	3   I absorbée	(A)			3.14	3.68	4.25	4.86	5.50
<b>60</b>	1   P frigorifique	(Watt)				965	1305	1714	2204
	2   P absorbée	(W)				805	954	1108	1268
	3   I absorbée	(A)				3.79	4.44	5.11	5.82

**50 Hz R404A**

**N°3605**

4   T condensation	5   T évaporation	(°C)	-40	-35	-30	-25	-20	-15	-10
<b>30</b>	1   P frigorifique	(Watt)	594	827	1106	1435	1818	2260	2767
	2   P absorbée	(W)	519	606	692	776	861	944	1028
	3   I absorbée	(A)	2.45	2.77	3.12	3.50	3.91	4.34	4.81
<b>40</b>	1   P frigorifique	(Watt)		729	999	1316	1687	2116	2609
	2   P absorbée	(W)		608	711	815	920	1026	1134
	3   I absorbée	(A)		2.79	3.22	3.67	4.16	4.67	5.21
<b>50</b>	1   P frigorifique	(Watt)			871	1175	1530	1943	2422
	2   P absorbée	(W)			712	836	962	1091	1223
	3   I absorbée	(A)			3.30	3.83	4.39	4.98	5.59
<b>60</b>	1   P frigorifique	(Watt)				1014	1352	1749	2215
	2   P absorbée	(W)				842	990	1142	1299
	3   I absorbée	(A)				3.97	4.60	5.27	5.96

1 = cooling capacity 2 = power input 3 = current 4 = condensing temperature 5 = evaporating temperature

**Nota : Tecumseh se réserve le droit de modifier les informations contenues dans ce document sans préavis.**

**Note : Tecumseh reserves the right to change information contained in this document without notification.**



**Tecumseh**

<b>AJ2446P-FZ</b>	<b>Tension FZ : 220 - 240V 1~ 50 Hz</b>
-------------------	---

Les performances sont données dans les **conditions Standard TE** :  
 Condition Mid

The performance data are in **Standard TE conditions** :  
 Mid Condition

Gaz aspirés : 32.0 °C  
 Sous refroidissement : 18.3 K

Return gas : 32.0 °C  
 Subcooling : 18.3 K

© 2023 Tecumseh Products Company  
 All rights reserved

**50 Hz R455A**

**N°3318**

4   T condensation	5   T évaporation	(°C)	-40	-35	-30	-25	-20	-15	-10
<b>30</b>	1   P frigorifique	(Watt)	494	731	1007	1327	1699	2127	2619
	2   P absorbée	(W)	462	556	645	729	808	883	951
	3   I absorbée	(A)	2.31	2.71	3.11	3.52	3.92	4.33	4.75
<b>40</b>	1   P frigorifique	(Watt)	402	641	915	1232	1598	2020	2505
	2   P absorbée	(W)	443	554	663	770	873	974	1072
	3   I absorbée	(A)	2.23	2.72	3.21	3.70	4.20	4.70	5.21
<b>50</b>	1   P frigorifique	(Watt)		530	797	1104	1458	1868	2340
	2   P absorbée	(W)		536	664	791	918	1043	1168
	3   I absorbée	(A)		2.64	3.21	3.80	4.39	4.98	5.57
<b>60</b>	1   P frigorifique	(Watt)			663	953	1288	1678	2133
	2   P absorbée	(W)			647	794	943	1093	1243
	3   I absorbée	(A)			3.14	3.81	4.49	5.16	5.85

**50 Hz R454C**

**N°3317**

4   T condensation	5   T évaporation	(°C)	-40	-35	-30	-25	-20	-15	-10
<b>30</b>	1   P frigorifique	(Watt)	422	637	892	1192	1543	1951	2421
	2   P absorbée	(W)	417	500	581	659	734	807	877
	3   I absorbée	(A)	2.12	2.47	2.82	3.17	3.53	3.89	4.26
<b>40</b>	1   P frigorifique	(Watt)	340	555	807	1103	1448	1849	2312
	2   P absorbée	(W)	399	495	592	689	785	880	975
	3   I absorbée	(A)	2.03	2.46	2.90	3.34	3.79	4.23	4.68
<b>50</b>	1   P frigorifique	(Watt)		450	694	979	1311	1699	2149
	2   P absorbée	(W)		474	585	698	813	930	1048
	3   I absorbée	(A)		2.35	2.87	3.40	3.93	4.46	5.00
<b>60</b>	1   P frigorifique	(Watt)			559	825	1137	1505	1936
	2   P absorbée	(W)			563	691	823	959	1099
	3   I absorbée	(A)			2.74	3.35	3.97	4.58	5.20

1 = cooling capacity 2 = power input 3 = current 4 = condensing temperature 5 = evaporating temperature

**Nota : Tecumseh se réserve le droit de modifier les informations contenues dans ce document sans préavis.**

**Note : Tecumseh reserves the right to change information contained in this document without notification.**