

T9 mobile air cooler

commercial and industrial mobile air cooler T9
 Easy operation, only need water and electricity supply
 Comfort: 3-8 oC temperature decrease
 Dust filtering and air freshening
 High efficiency, one unit can cover 150 m2 area
 UV-resistant plastic cabinet
 Auto swing diffuser to cover 120° area

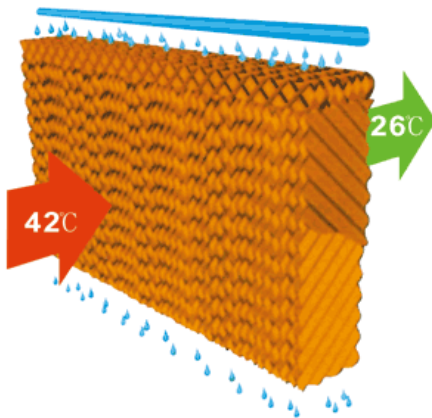

Working principle

Nature's most efficient means of cooling is through the evaporation of water. Evaporative cooling works on the principle of heat absorption by moisture evaporation. It also happens on human skin, the body sweat to cool temperature down.

JHCOOL evaporative cooler produces effective cooling by combining the natural process water evaporation with a simple, reliable air moving system. Fresh outside air is filtered through the saturated evaporative media, cooled by evaporation, and circulated by a blower.

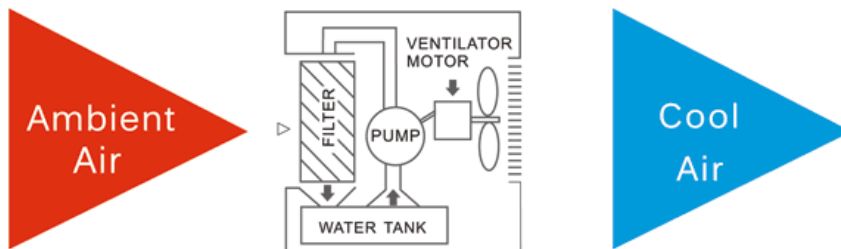

Advantages of evaporative air cooling



Low carbon green product, environmentally friendly, no CFC'S, no damage to the Ozone layer



Super energy-saving, only cost 1/10 electricity than air con



Less than 1/2 the price of air conditioning



Vent cooling, no air re-circulation

Suitable for big building , support 15~20m single ducting, or multi ducts be divided into 3~4 rooms.



Higher quality standard

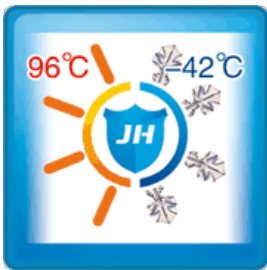

Highest quality UV-resist plastic cabinet, temperature tolerance from -42~96°C

Strongest plastic cabinet for cooler

Better parts



Luxury designed big LCD screen wall controller with temperature and humidity sensor



Permanent magnet synchronous motor high foot water pump, double rotate, automatically eject foreign matter out



High quality sealed alluminum motor. Water proof and good heat dissipation performance.

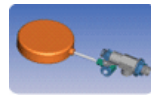

Unique designed float valve, available water pressure from 0 bar to 5.5bar.

More functions

Mitsubish core, Computerized control circuit, 5 big protections





More healthy, more clean air



Auto clean function, To change water every several hours

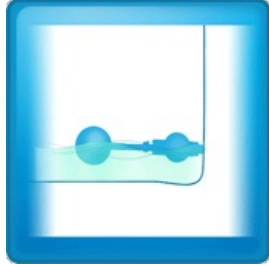

Shut down clean, off dry

Evaporative Cooling Pad



High quality sealed aluminum motor
Water proof and good heat dissipation performance



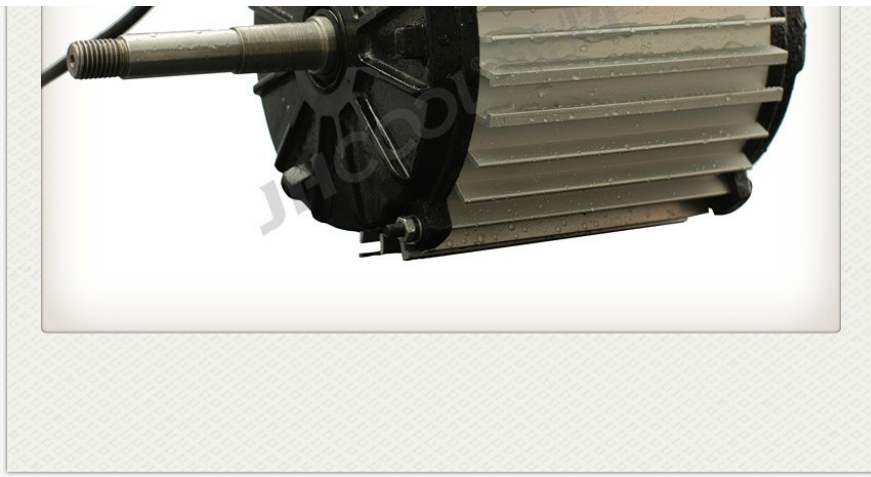

Fan blade





Luxury LCD wall controller
big white LCD display
temperature display
humidity display
auto on/off
date and time clock



Inlet Valve
Extra filter built in



Permanent magnet synchronous motor
High foot frame, air cooled motor
no burn run without water
eject foreign matter out



Drain Valve
50000 times super long life time
drain old dirty water out of cooler automatically





Air Diffuser

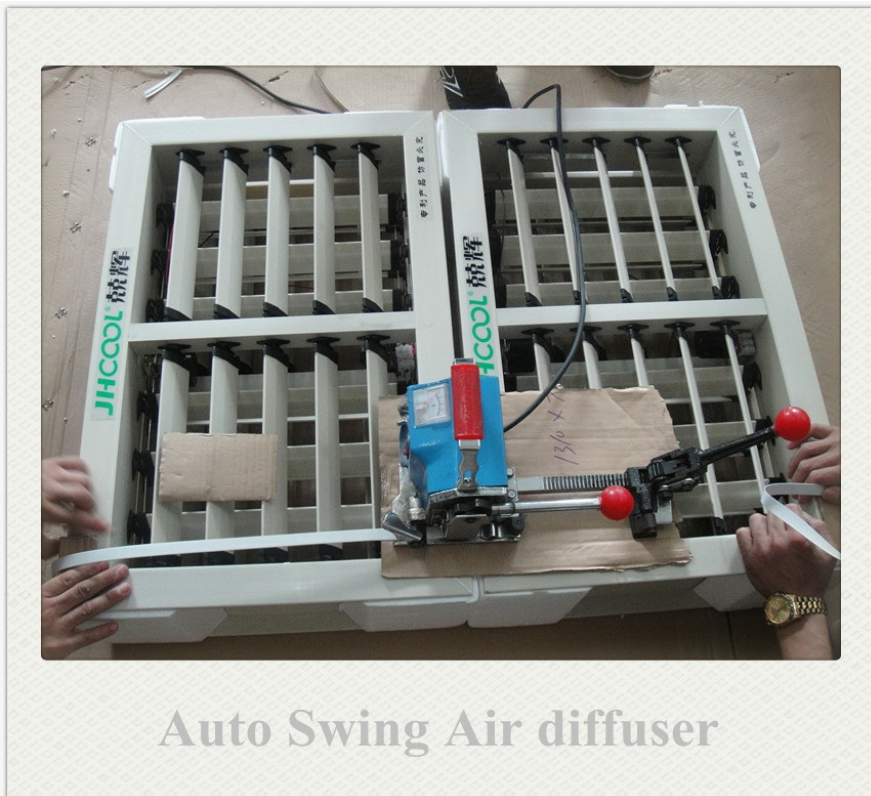

Auto Swing Air diffuser

Electric	Power	1.1kw
	Speed	16
Fan	Single unit cover area	100~150m ²
	Airflow (M3/H)	18000
	Fan type	Axial
	Pressure	180Pa
	Noise	<73db
Cabinet	Cabinet	Plastic
	Discharge type	top
	Dimension (mm)	1160*1160*1760
	Packed size (mm)	1170*1170*1120+730x890x370
	Loading quantity (assembled) in 40HQ	40pcs
	Net weight	90kg
	Water Tank	30L
Control	Control type	LCD
	Remote	yes
	Overload protect	yes
	Pump protect	yes
	Temperature & humidity	yes
	Pre-cooling	option