



全封闭滚动转子式制冷压缩机 规格书

Rotary Air-conditioning Compressors Specification

型号 Mdel	YZG-48RCT3
客户名称 The Customer	
客户签名及时间 Signature & Date	

本规格书从贵公司确认之日起生效. 贵公司负责人承认签名之后请返回我公司一份。

This document will be effective with your authorized signature .please return one copy of this document.

拟制 Compile : _____

审核 Examine : _____

批准 Approve : _____

西安庆安制冷设备股份有限公司

Xian Qingan Refrigeration Equipment Co., Ltd

共 9 页/9 page altogether

1. 压缩机规格	Specification of Compressor
1.1 应用类型：房间空调器	Application scope: room air conditioners
1.2 额定电压/频率/相数 220-240V~/50Hz/1	Rated Voltage/Frequency/Phase 220-240V~/50Hz/1
1.3 制冷剂：R22	Refrigerant: R22
1.4 环境温度范围：-5~43℃	Range of Ambient temperature:-5~43℃
1.5 蒸发温度范围:-10~15℃	Range of evaporating temperature:-10~15℃
1.6 冷凝温度范围：45~65℃	Range of Condensing temperature:45~65℃
1.7 气缸容积：29.4cm ³ /rev	Working capacity: 29.4cm ³ /rev
1.8 额定制冷量：4850W (220V)	Rated capacity: 4850W (220V)
1.9 电机输入功率：1650W (220V)	Motor input power: 1650W (220V)
1.10 运行电流：7.65A (220V)	Running current: 7.65A (220V)
1.11 能效比：2.95 W/ W	EER: 2.95 W/ W
1.12 冷冻机油：4GSDI	Refrigeration oil: 4GSDI
1.13 注油量：500mL	Amount of oil charge: 500mL
1.14 净重：16.8kg	Net weight: 16.8kg
1.15 电机	Motor
电机型式	Type
电容运转型	Permanent Split Capacitorted
堵转电流：40A (220V)	Locked rotor amps: 40A (220V)
运转电容：40μF/450V·AC	Running capacitor: 40μF/450V·AC
绝缘等级：B 级	Insulation class: Class B
主\辅绕组阻值：1.57/3.16Ω (at 20℃)	Winding resistance(M\S): 1.57/3.16Ω (at 20℃)
外置式复合保护器：B300-150-141C	Outer compound protector: B300-150-141C
1.16 工况条件	Working conditions
名义工况	Nominal
过负荷工况	Overload
蒸发温度 7.2℃	Evaporating temperature 7.2℃
10.0℃	10.0℃
冷凝温度 54.4℃	Condensing temperature 54.4℃
65.8℃	65.8℃
过冷度 8.3℃	Super-coding temperature 8.3℃
5℃	5℃
吸气温度 35.0℃	Suction gas temperature 35.0℃
18.0℃	18.0℃
环境温度 35.0℃	Ambient temperature 35.0℃
25.0℃	25.0℃
1.17 其它性能	Specific performance
电机绕组温度：130℃ max	Temperature of motor winding: 130℃ max
振动：40m/s ² max	Vibration: 40m/s ² max
噪声：58dB(A) max	Noise: 58dB(A) max
气密性试验压力：2.95Mpa	Leakage testing pressure: 2.95Mpa
强度试验压力：10.5Mpa	Mechanical strength pressure: 10.5Mpa
绝缘电阻：≥30MΩ	Insulation resistance: ≥30MΩ
电气强度:1500V 1min 或 1800V 1sec	Electric strength: 1500V 1min 或 1800V 1sec
残余水分：200mg max	Residual moisture: 200mg max
残余杂质：40 mg max	Residual impurity: 40 mg max
2. 使用条件	Operating Conditions
2.1 最低起动电压：额定电压的 85%。	Start-up voltage (min): 85% of rated

- 2.2 运转电压范围：额定电压的±10%。
Running voltage range: ±10% of rated voltage.
- 2.3 压缩机安装时,与水平地面的最大倾斜角不能超过 5°。
When the compressor has been installed into the refrigerating system, it should remain perpendicular to the leveling floor with max inclination no more than 5°.
- 2.4 压缩机开停运转时,每次停机时间应大于 3min。
The period of turning down and restarting the compressor should be more than 3 minutes.
- 2.5 制冷系统（不包括压缩机）的水分含量不应超过 60ppm，杂质含量不应超过 20mg。
The residual moisture in the refrigerating system(not include the compressor) should not exceed 60ppm, the residual impurity in the refrigerating system(not include the compressor) should not exceed 20mg.
- 2.6 制冷剂注入量 1600g max。
The filling amount of refrigerant should not 1600g.
- 2.7 安装电器罩时，六角法兰面螺母拧紧力矩为 1.8N·m。
When the electric container cap is installed, the nut screw moment is 1.8 N·m.

3. 零件及图样清单 Parts and drawing list

零件名称 Parts name	代号 Code	数量/套 QTY/Set	备注 Remarks
压缩机 Compressor	YZG-48RCT3	1	外形图 Shape
电器罩 Electric container cap	YZG/AZ-00-04	1	
六角法兰面螺母 Hexagon flange surface nut	GB/T6177.1-2000-M5	1	
橡胶垫 Rubber pad	YZG/AZ-00-08B	1	
减振支承座 Absorber support	YZG/AZ-00-02	3	
外置式复合保护器 Outer compound protector	B300-150-141C	1	
电容 Capacitor	40μF/450V·AC	1	用户自备 Self provided
			电气接线图 Electric wiring diagram
			附件安装图 Accessories installation diagram

4. 规格书有效期 The period of validity

本规格书经贵公司确认之日后即生效。若更改须重新确认生效，以前之规格书自动失效。
This document will take effect after the confirmation of your company with the authorized signature when design modification is approved by the customer, the current document is unavailable.

压缩机外形图 Compressor shape

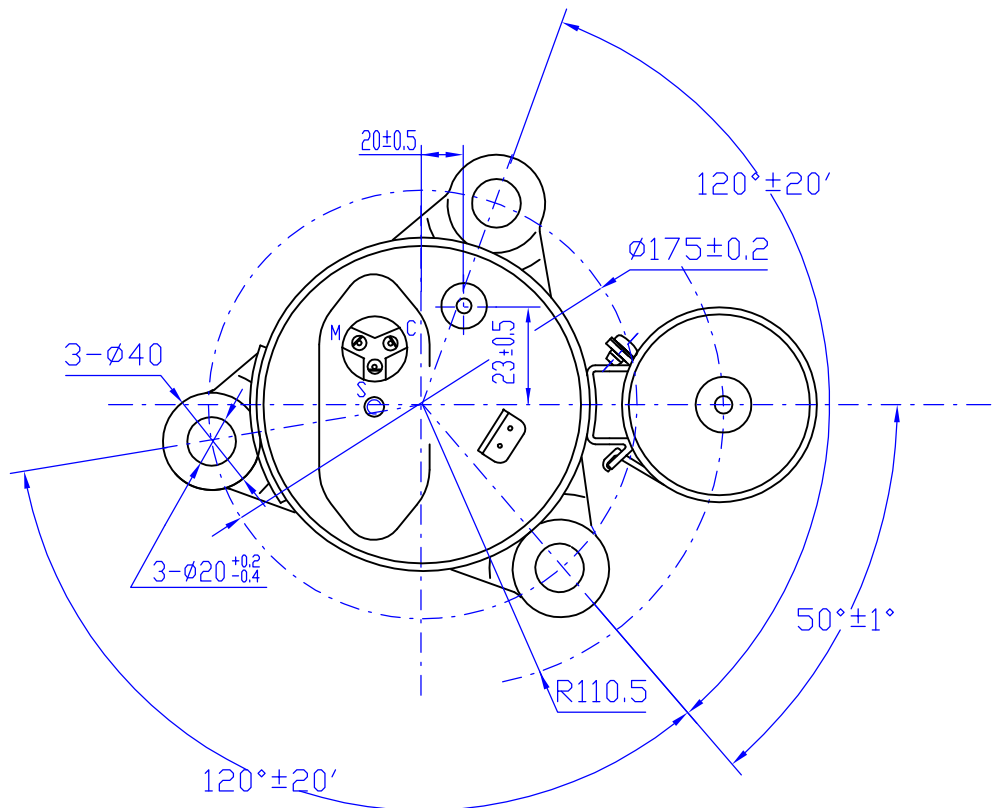
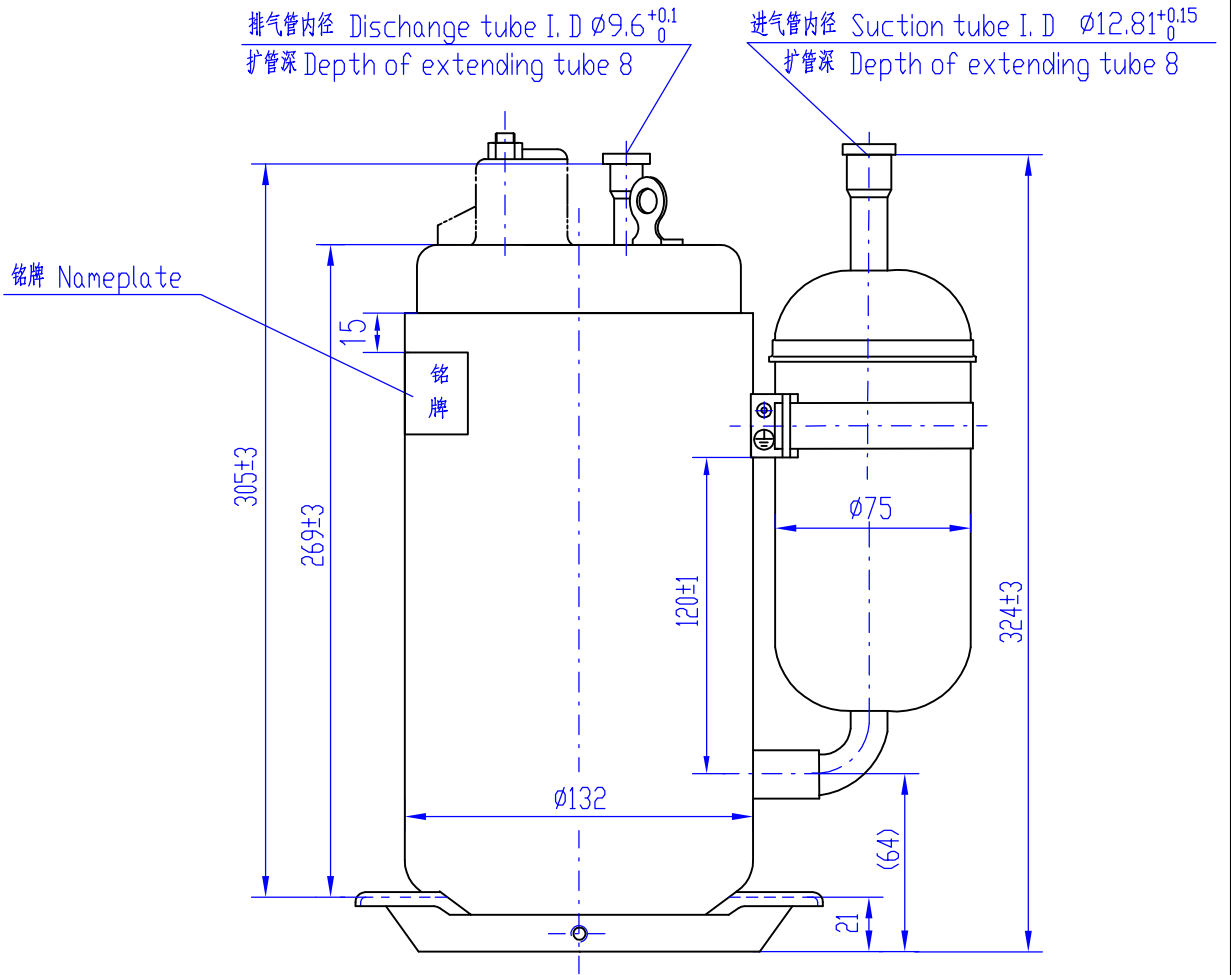

Dimension : mm

压缩机电气接线图 Compressor electric wiring diagram

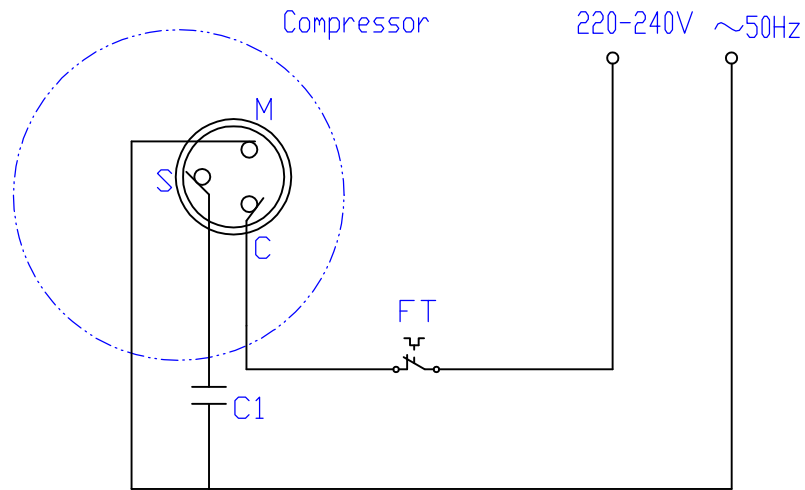

M 主绕组 Main winding S 辅绕组 starting winding
 C 公共绕组 Common winding C1 电容器 Capacitor
 注: FT 外置式复合保护器B300-150-141C安装在压缩机外。
 Note: The protector is inside of compressor.

压缩机接地方式 Compressor grounding method

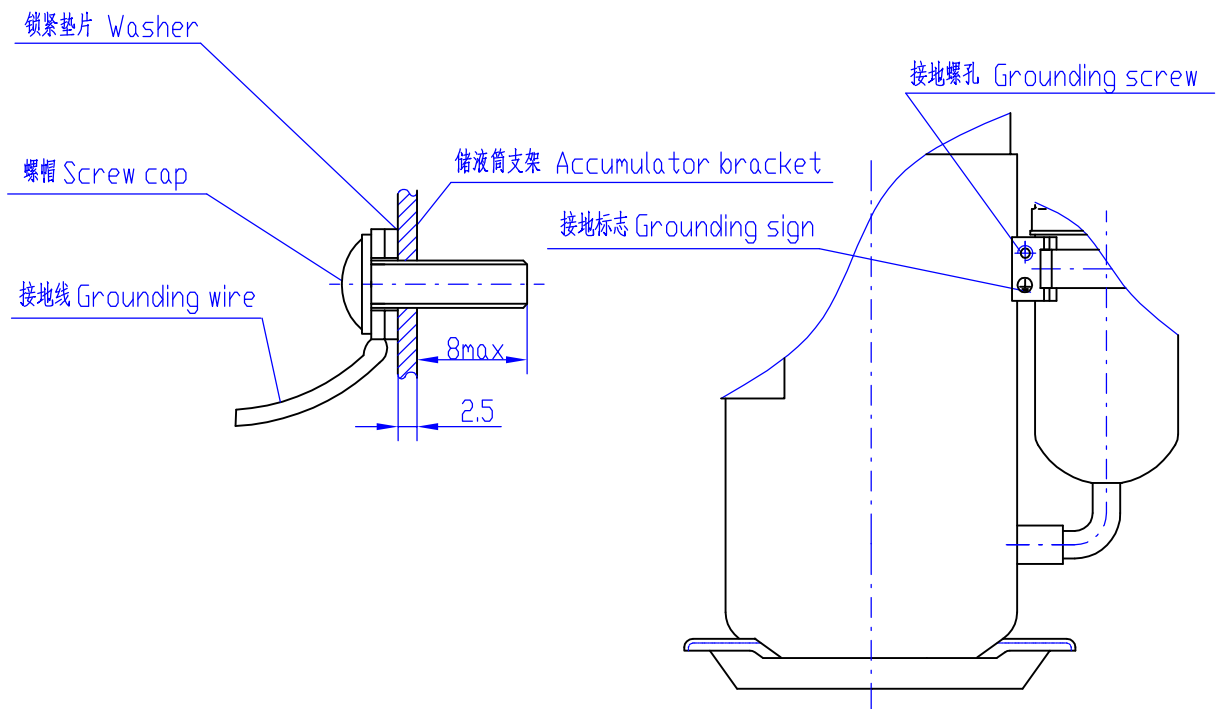

Dimension : mm

名称 Name	电 器 罩 Electric container cap	代号 Code	YZG/AZ-00-04
---------	------------------------------	---------	--------------

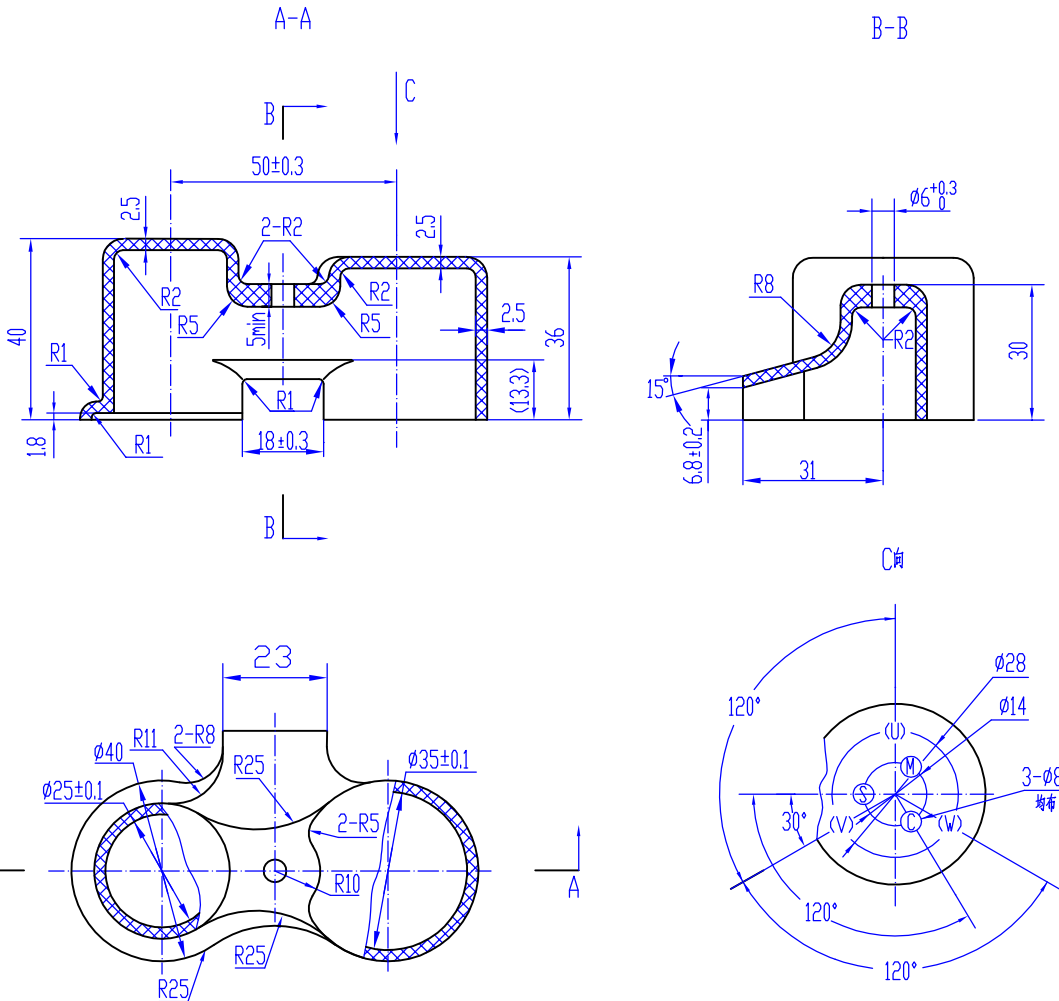

材料: 阻燃聚酰胺66 Material: Nylon 66.
Dimension: mm

名称 Name	六角法兰面螺母 Hexagon flange surface nut	代号 Code	GB/T6177.1-2000-M5
---------	---------------------------------------	---------	--------------------

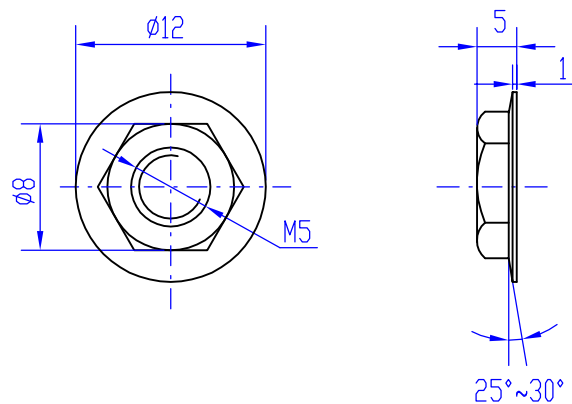

Dimension: mm

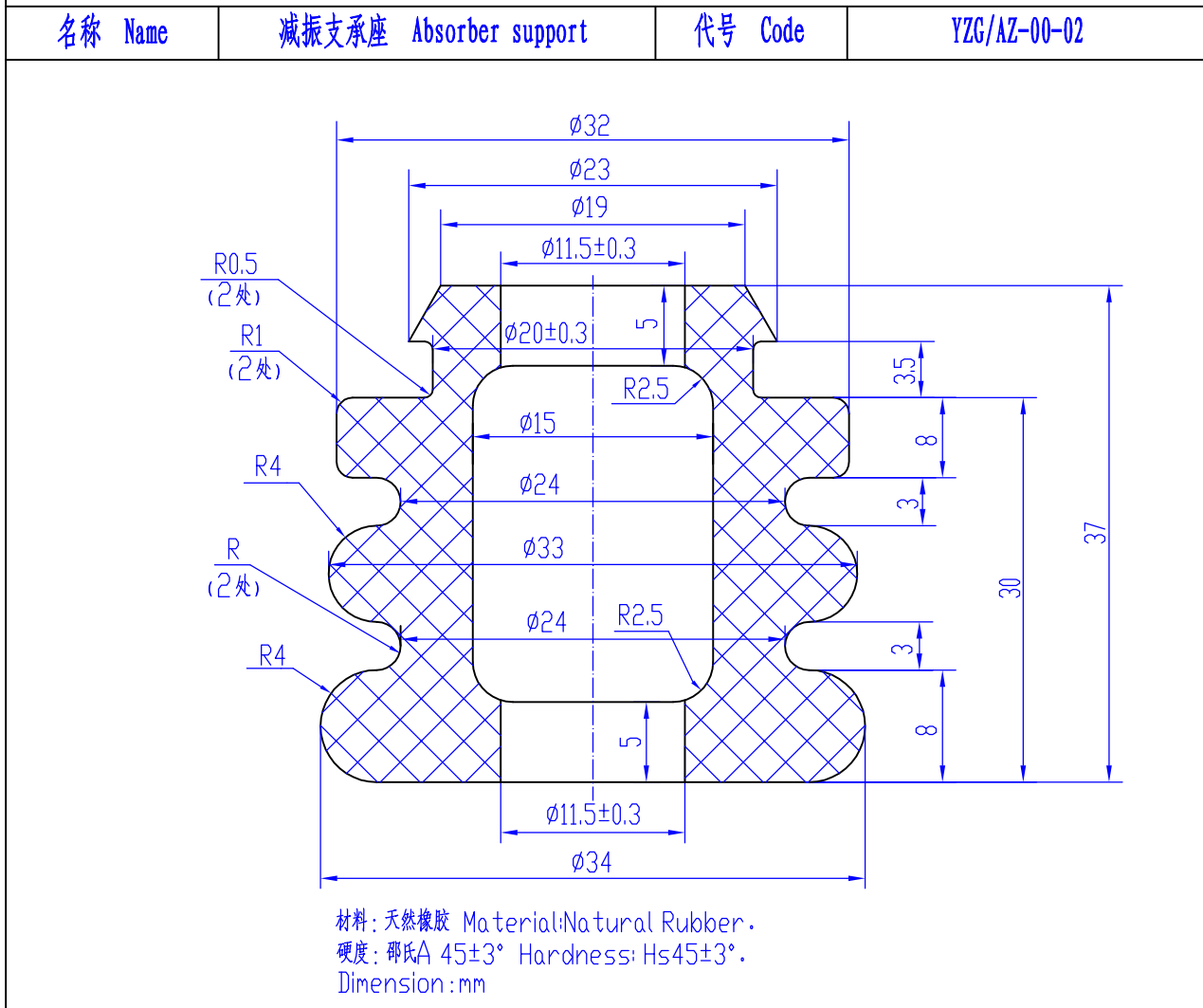
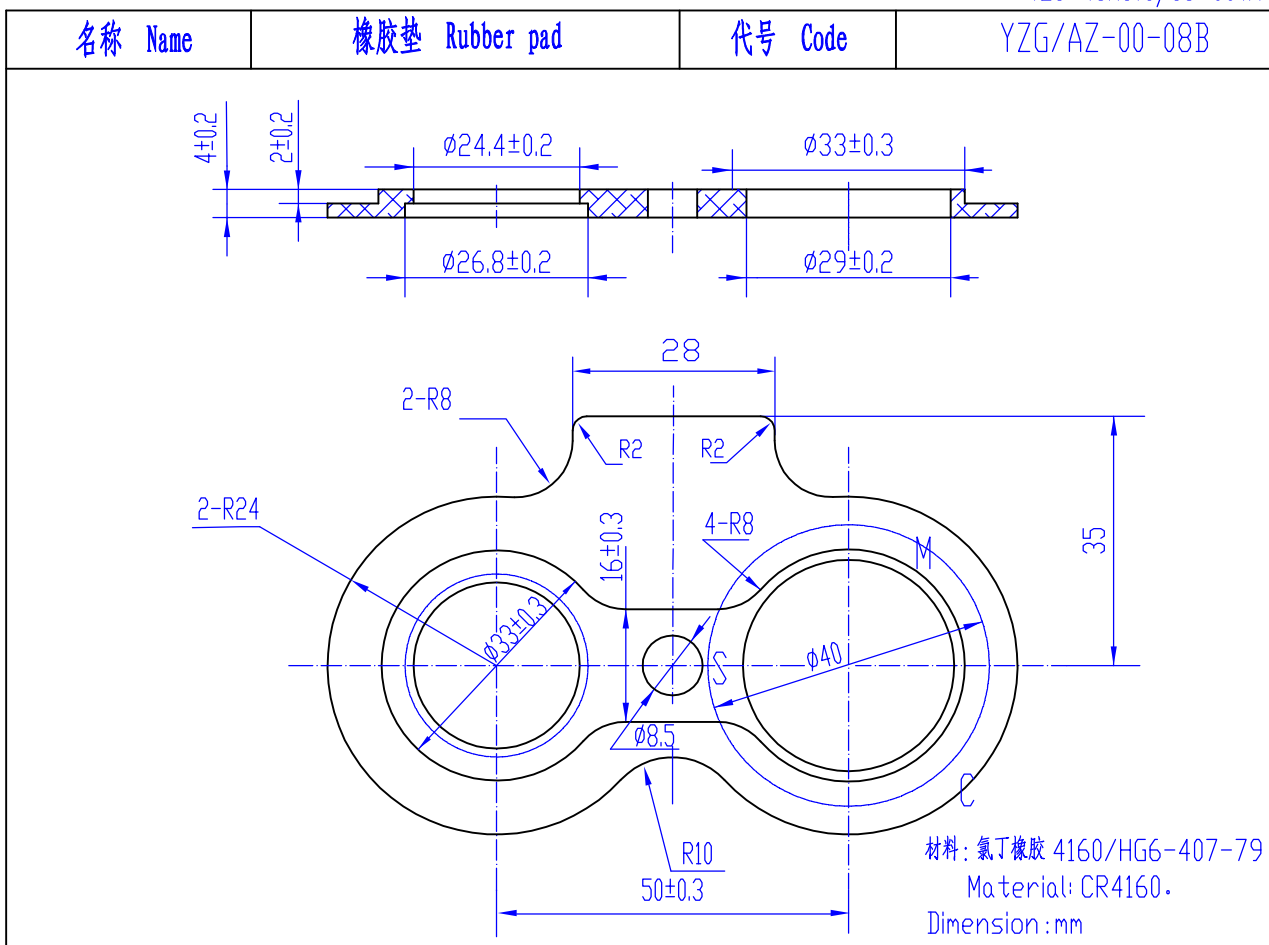

压缩机附件安装图 Accessories installation diagram

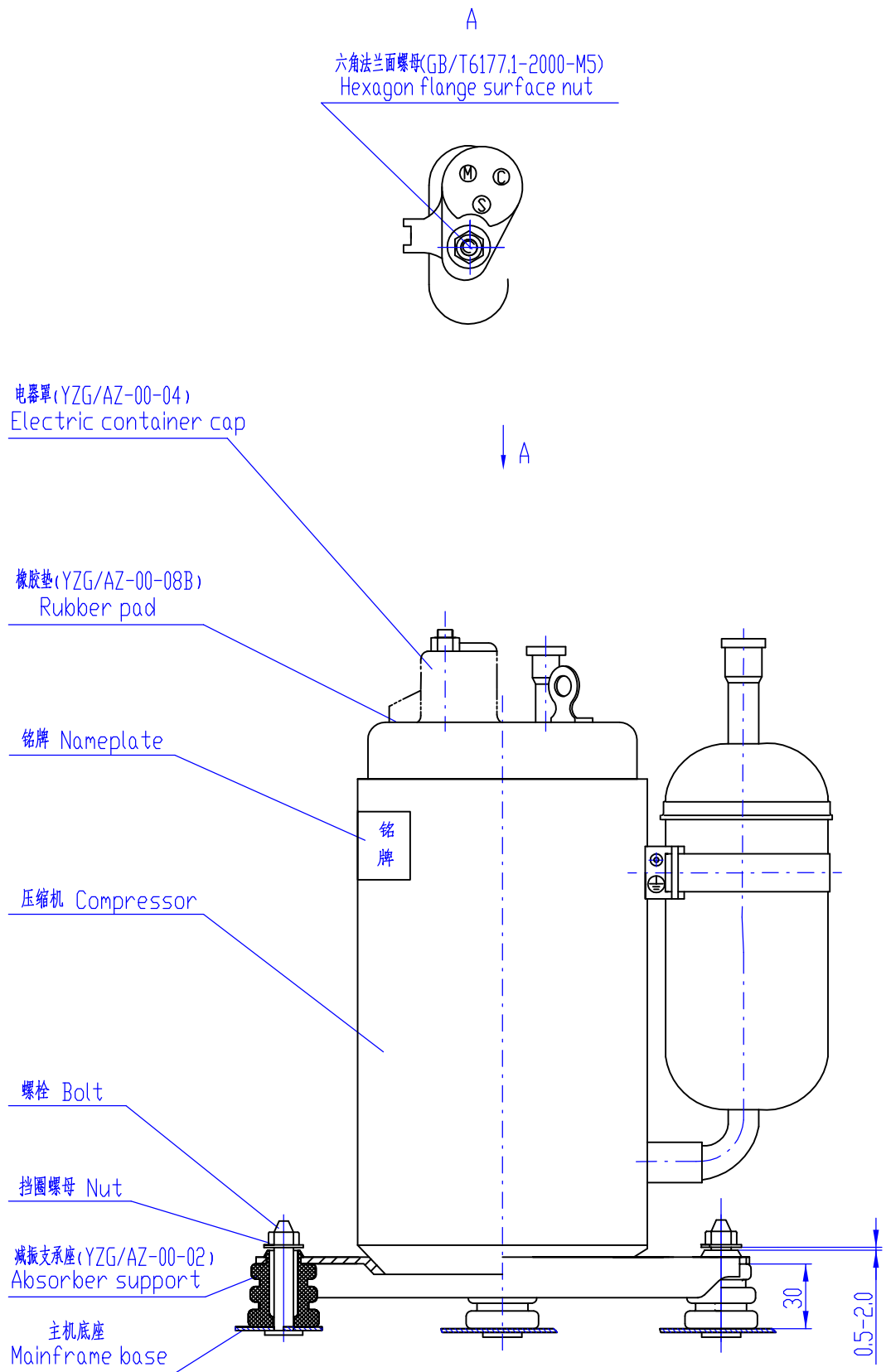

Dimension : mm

名称 Name	外置复合保护器Outer compound protector	代号 Code	B300-150-141C
---------	---------------------------------	---------	---------------

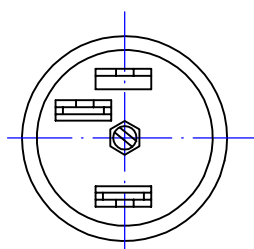
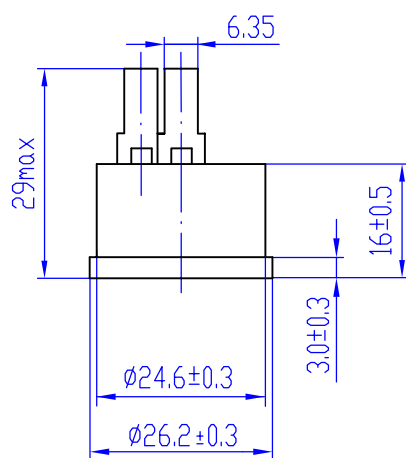

Dimension : mm