

Tolerance Class	Basic Size Range (mm)							
	0.5~3	>3~6	>6~30	>30~120	>120~400	>400~1000	>1000~2000	>2000~4000
Very Coarse	-	±0.5	±1	±1.5	±2.5	±4	±6	±8

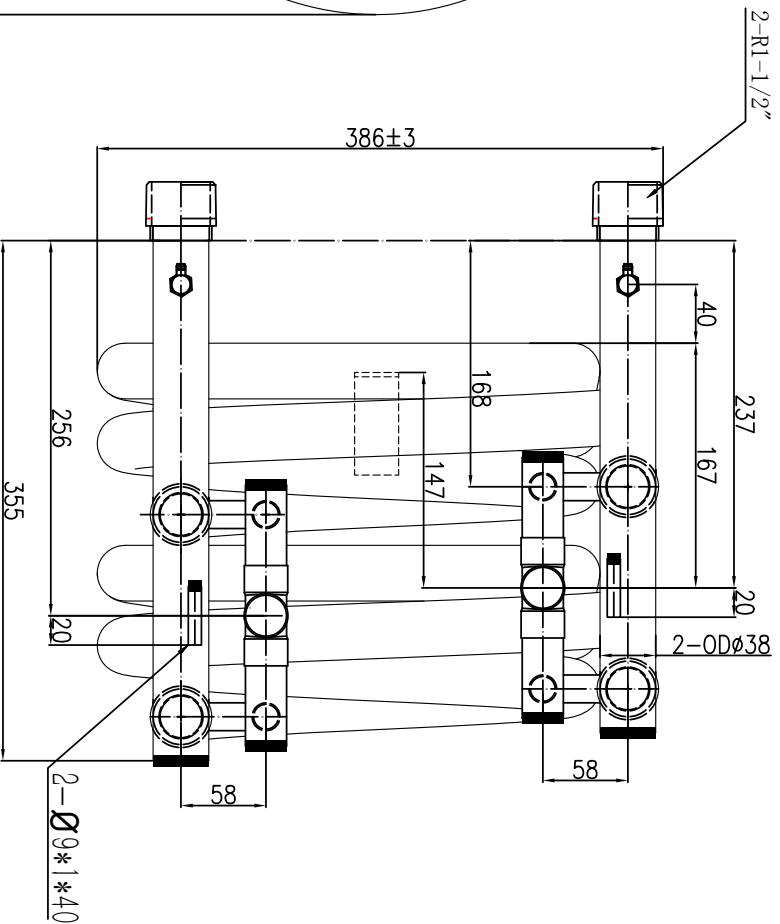
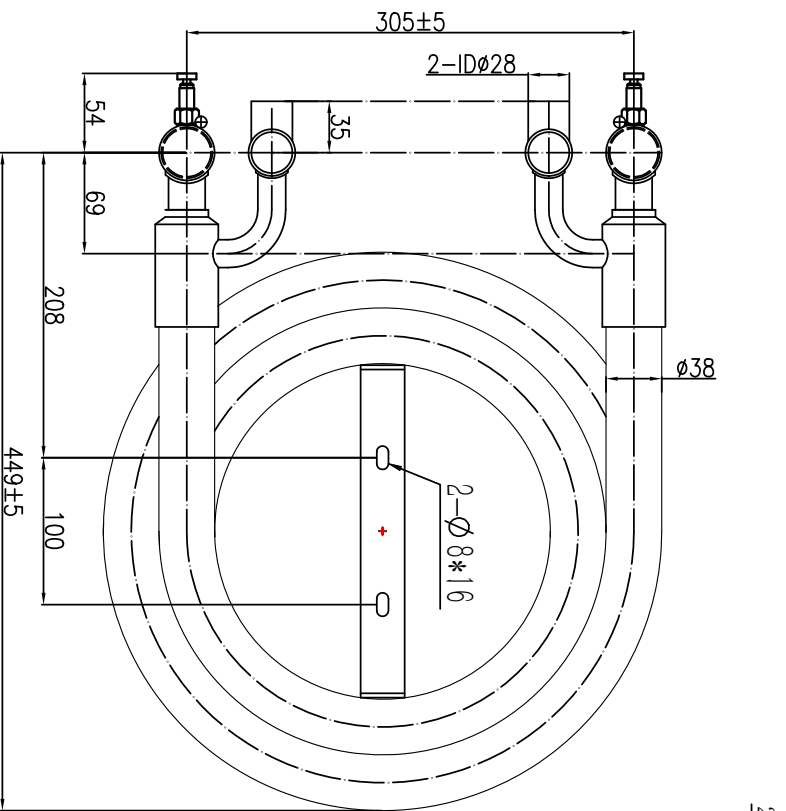

Technical Specifications

1. Inner tube and outer tube should be cleaned so that ensure the surface of the inner and outer tube to be clean without impurities;
2. All welded place should be well welded, Any defect on small holes and leaks is unacceptable;
3. Heat exchanger is black painted except 25±5mm cylinder from connectors end;
4. Each end connection should be sealed by a plastic cap or welding;
5. Fill 0.05~0.12Mpa nitrogen gas at refrigerant side, the pressure is maintained;
6. Any non-indicated dimensions and tolerances are subject to GB/T1804 V degree;
7. Other non-indicated requirements are subject to (GB/T 23802-2010).

Design Data Sheet				Coaxial Heat Exchanger					
Team	Tube Side	Shell Side		Inner tube: Copper Outer tube: Steel					
Medium	Water	R410A							
Design Temp./°C	65	100	Mark No.	Modify Documents No.	Sign	Date	Drawing Mark	Weight	Scale
Design Pressure/PSI	400	600	Design	Standard	Authorize				
Insulation			Check				Total Page	Page	SS-0600GT-P-S CSSP6001022
Customer Drawing No.			Approve						
Customer Team No.			Process						