

DIMENSIONS OF ALARM CONTROL UNIT

1.4



DIMENSIONS OF EMERGENCY PUSHBUTTON UNIT

1.5



IDENTIFICATION DATA

1.6

The unit described in this manual has, on its side, an ID plate showing all the relevant identification data:

- Name of Manufacturer
- Code of the UNIT
- Serial number
- IP protection rating
- Power supply voltage

	MADE IN ITALY	Code:	100APE03
		S.N.:	1015000239
RoHS compliant 		Date:	21/06/17
		Power supply:	230Vac +/- 10%
		Frequency:	50/60Hz
		Protection:	IP43
		Operating temperature:	-5...+45°C

1.7

DESCRIPTION OF SYSTEM

The purpose of this safety system is to allow a person trapped inside the cold room to activate an acoustic/luminous alarm located outside the room and so request help. The system has been designed to function even in the event of a temporary mains power failure: in this event the system is powered by a buffer battery housed in the external unit. It conforms to the **UNI EN 378-1: 2016**, applicable to cold rooms at negative temperatures and with a volume greater than 10 m³.

The system consists of the following parts:

- **Emergency pushbutton to be fitted inside the cold room.**
Consists of a luminous mushroom-type button with N.C. contact. The pushbutton is permanently lit by LEDs so that it can be located in the dark.
- **Acoustic/visual alarm control unit to be fitted outside the cold room.**
Features a siren and flashing light and a buffer battery to provide power in the event of a black-out. There is also a clean contact (closed with alarm on) that can be used to activate other devices such as a remote warning dialler or additional sirens.

Connection between the two devices - consisting of a lead laid by the installer as per the wiring diagram - is ensured by the system safety logic. Should the lead be cut or disconnected the alarm will be activated immediately.

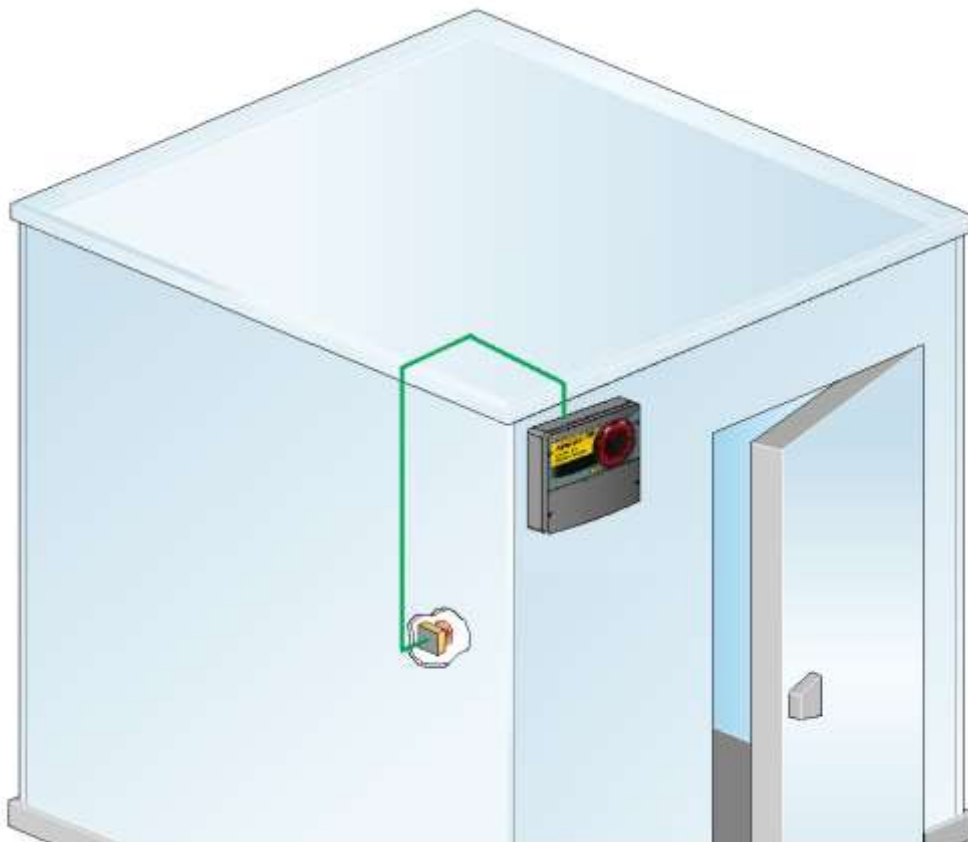

CHAPTER 2: INSTALLATION

INSTALLING THE OUT-OF-ROOM ALARM CONTROL UNIT

2.1

1. Undo the 4 closure screws on the front panel.



2. Use the three existing holes to fix the box back panel to the wall: use three screws of a length suitable for the thickness of the wall to which the panel will be attached. Fit a rubber washer (supplied) between each screw and the box backing.

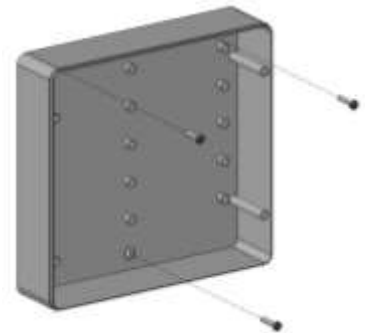

Make all the electrical connections as illustrated in the diagram for the corresponding model (see relative table in APPENDICES). To effect correct electrical connection and maintain the protection rating, use appropriate wire/raceway grips to ensure a good seal. Route the wiring inside the unit in as tidy a fashion as possible: be especially careful to keep power wires away from signal wires. Use clips to hold wires in place.

3. Re-close the front panel, making sure that all the wires are inside the box and that the box seal sits in its seat properly. Tighten the front panel using the 4 screws, making sure the O-rings on the head of each screw are used.



2.2**INSTALLING THE IN-ROOM EMERGENCY PUSHBUTTON**

1. The in-room pushbutton must be positioned so that it is always visible and easily reachable.
2. Undo the four closure screws on the front of the pushbutton panel.
3. Using the four internal holes fix the box backing with four screws of a length suitable for the thickness of the wall to which it is to be attached.

**2.3****OPERATION AND MAINTENANCE**

- Carry out the connections as per the wiring diagram.
- After initial connection it will take 110 hours to fully charge the battery.
- Press the luminous pushbutton installed inside the cold room to activate the acoustic and luminous warning devices on the external alarm control unit. The auxiliary relay contact closes.
- In the event of a 230 V AC power failure the buffer battery will intervene and power the system for the duration indicated on the technical characteristics chart.
- Reset the emergency switch inside the cold room to cancel the alarm.
- Periodically check that the buffer battery is working properly.
- If the battery is replaced make sure it is disposed of properly at an authorised waste collection facility.
- If the alarm is tripped without the pushbutton being pressed check the connection lead and the connections between the pushbutton and external control unit.

SPARE PARTS:

Buffer battery: 100APEBATT

EXPLODED DIAGRAM

2.4

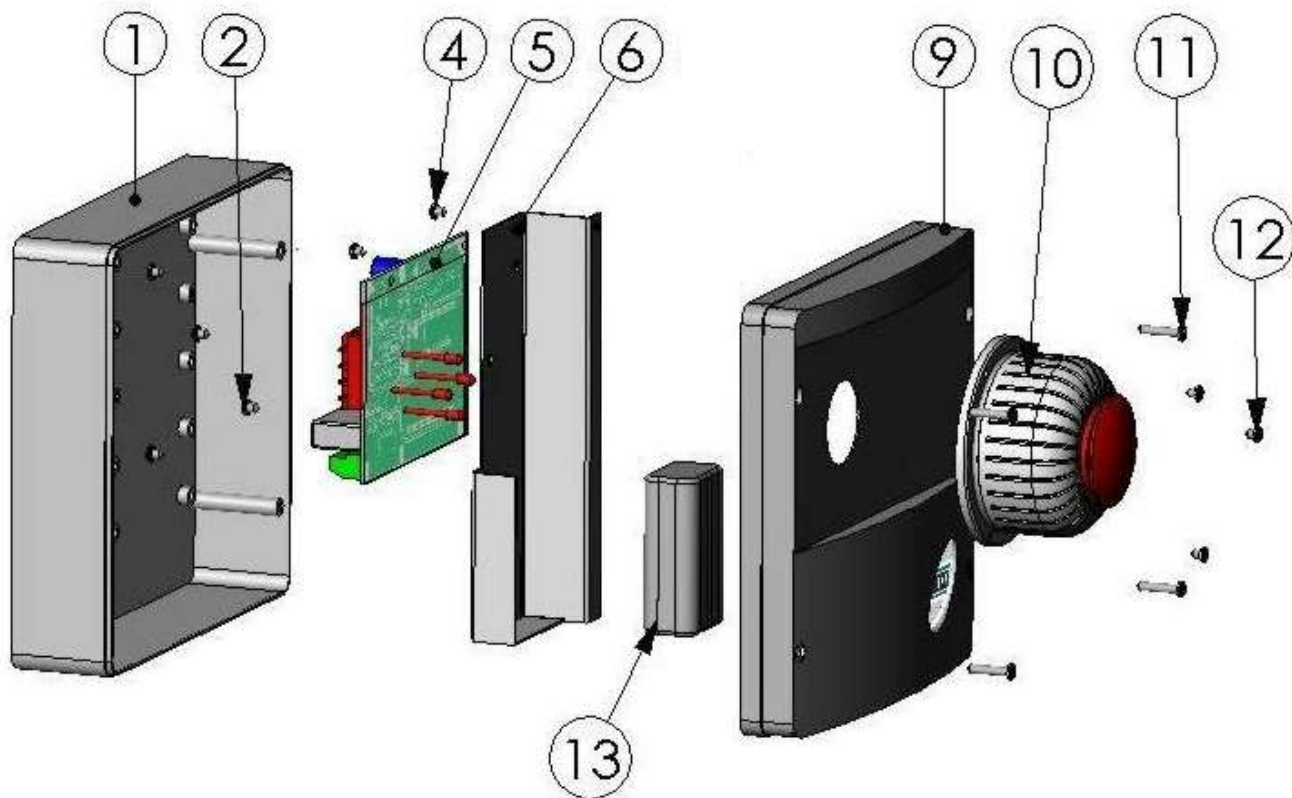

KEY

REF	DESCRIPTION
1	BOX BACKING IN ABS
2	BOARD ATTACHMENT SCREWS
4	BUFFER BATTERY SUPPORT FIXING SCREWS
5	BOARD
6	BUFFER BATTERY SUPPORT METAL SHEETING
9	FRONTAL SECTION IN ABS
10	ACOUSTIC/VISUAL ALARM
11	BOX CLOSURE SCREWS
12	ACOUSTIC/VISUAL ALARM ATTACHMENT SCREWS
13	BUFFER BATTERY

2.5

ELECTRICAL CONNECTIONS

Warning: The positive pole of the battery (Fastom with red wire) is initially disconnected to maintain the charge during product storage. Once the in-room keypad connections have been made it is, therefore, necessary to connect this fastom to the connector marked (1) on the upper left side of the board as also indicated on the wiring diagram.

It is advisable to first connect the control unit to the relative emergency pushbutton and only then connect up the battery and the mains power. This will prevent activation of the alarm.

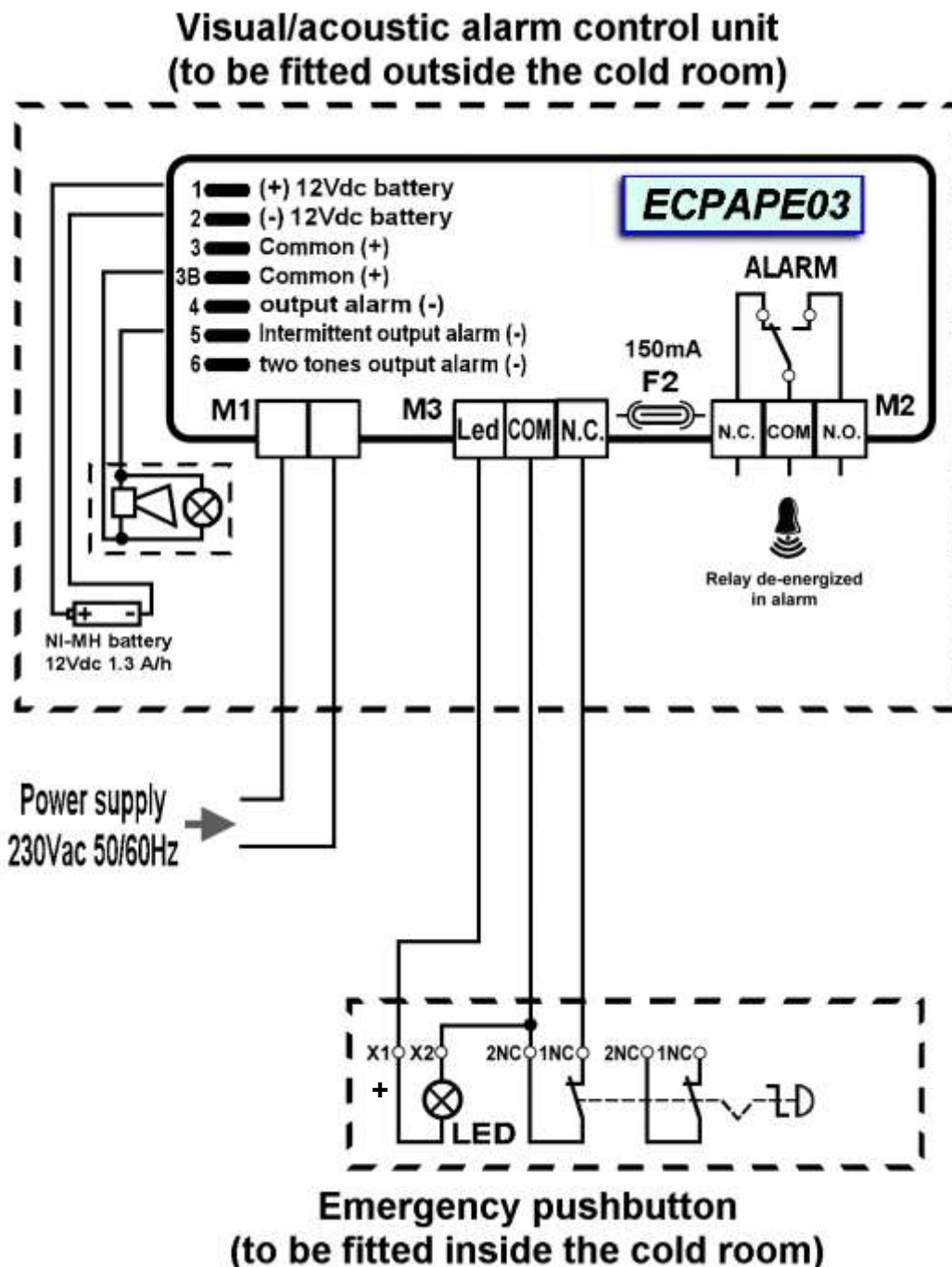

WARRANTY TERMS

2.6

The man in cold room alarm kit is covered by a 24-month warranty against all manufacturing defects as from the date indicated on the product ID code. If the system malfunctions as a result of tampering, impact or improper installation the warranty will automatically be rendered null and void. It is strongly recommended that you observe all instructions/information regarding the technical characteristics of the device.



Any modifications made to wiring and/or internal components or any work carried out in a way that fails to comply with the information/instructions in this manual shall render the warranty null and void immediately. Modifications/improper work can also cause malfunctions, irreparable damage, serious injury or put persons/objects in danger.



PEGO S.r.l. cannot be held liable for possible errors or inaccuracies written in this manual as a result of printing or transcription errors.

PEGO S.r.l. reserves the right to modify its products as it deems necessary without altering its main characteristics. Each new release of a **PEGO** user manual replaces previous ones.

APPENDICES

EU DECLARATION OF CONFORMITY

A.1

LA PRESENTE DICHIARAZIONE DI CONFORMITA' E' RILASCIATA SOTTO LA RESPONSABILITA' ESCLUSIVA DEL FABBRICANTE:
THIS DECLARATION OF CONFORMITY IS ISSUED UNDER THE EXCLUSIVE RESPONSIBILITY OF THE MANUFACTURER:



PEGO S.r.l. Via Piacentina 6/b, 45030 Occhiobello (RO) – Italy –

DENOMINAZIONE DEL PRODOTTO IN OGGETTO / DENOMINATION OF THE PRODUCT IN OBJECT

CODICE CODE	ECPAPE03
DESCRIZIONE DESCRIPTION	Allarme uomo in cella Man in cold room Alarm

IL PRODOTTO DI CUI SOPRA E' CONFORME ALLA PERTINENTE NORMATIVA DI ARMONIZZAZIONE DELL'UNIONE EUROPEA:
THE PRODUCT IS IN CONFORMITY WITH THE RELEVANT EUROPEAN HARMONIZATION LEGISLATION:

Direttiva Bassa Tensione (LVD): **2014/35/UE**

Low voltage directive (LVD): **2014/35/EU**

Direttiva EMC: **2014/30/CE**

Electromagnetic compatibility (EMC): **2014/30/EU**

LA CONFORMITA' PRESCRITTA DALLA DIRETTIVA E' GARANTITA DALL'ADEMPIMENTO A TUTTI GLI EFFETTI DELLE SEGUENTI NORME:
THE CONFORMITY REQUIRED BY THE DIRECTIVE IS GUARANTEED BY THE FULFILLMENT TO THE FOLLOWING STANDARDS:

Norme armonizzate: **EN 60335-1:2012, EN 378-1:2016, EN 61000-6-1:2007, EN 61000-6-3:2007**

European standards: **EN 60335-1:2012, EN 378-1:2016, EN 61000-6-1:2007, EN 61000-6-3:2007**

IL PRODOTTO E' COSTITUITO PER ESSERE INCORPORATO IN UNA MACCHINA O PER ESSERE ASSEMBLATO CON ALTRI MACCHINARI PER COSTITUIRE UNA MACCHINA CONSIDERATE DALLA DIRETTIVA: 2006/42/CE "Direttiva Macchine".

THE PRODUCT HAS BEEN MANUFACTURED TO BE INCLUDED IN A MACHINE OR TO BE ASSEMBLED TOGETHER WITH OTHER MACHINERY TO COMPLETE A MACHINE ACCORDING TO DIRECTIVE: EC/2006/42 "Machinery Directive".

Firmato per nome e per conto di:
Signed for and on behalf of:

Pego S.r.l.
Lisa Zampini
Procuratore Generale

Luogo e Data del rilascio:
Place and Date of Release:

Occhiobello (RO), 08/01/2018