

SPECIFICATIONS	
ES NO.	DESCRIPTION
ES81-159	CLEANLINESS
ES81-250	IDENTIFICATION
ES92-167	REGULATORY COMPLIANCE
ES22-122	PACKAGING

NOTES:

- MARK PART NUMBER PER ES81-250-7.
- ALL CORNERS 0.010 RADII, UNLESS OTHERWISE SPECIFIED.
- THREADED INSERT MUST NOT TURN WHEN 20 INCH POUNDS OF TORQUE IS APPLIED.
- Q.C. TO INSPECT THESE DIMENSIONS ONLY.

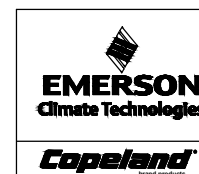
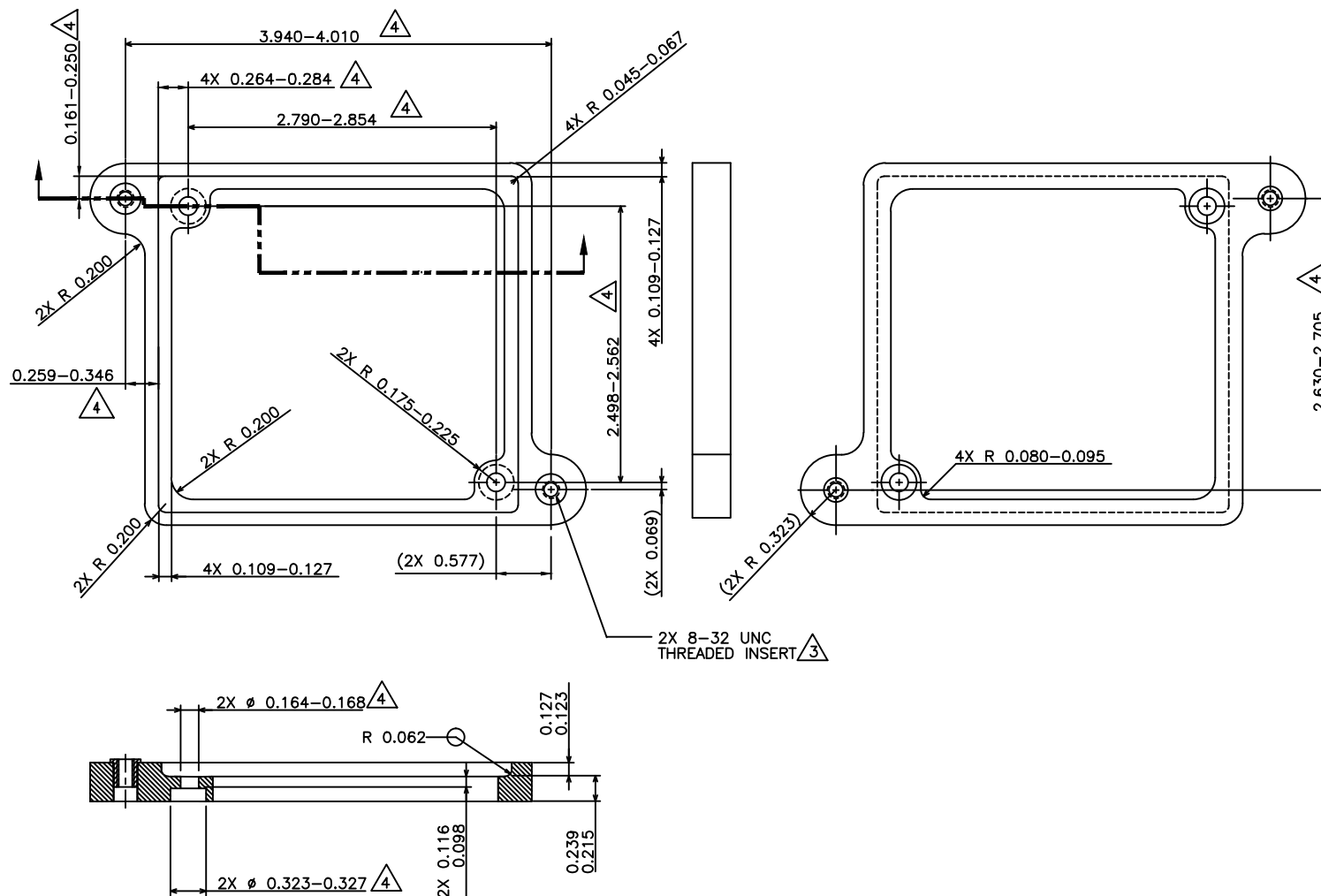

INTERPRET PER ASME
Y14.5M-1994 AND
EMERSON CLIMATE
TECHNOLOGIES, INC.
DESIGN STANDARDS D52002
DO NOT SCALE DRAWING
THIRD ANGLE PROJECTION
UNLESS OTHERWISE SPECIFIED
DIMENSIONS ARE INCH OR (MILLIMETER)
TOLERANCES:
2-PLACE ± N/A
3-PLACE ± 0.005
ANGULAR ± 0.5°

31-0905-045	3	REDRAWN WITH CHANGES	01-28-09	VDK	WF
31-0905-045	0	RELEASED	10-05-05	AK	DE
ENG NOTICE NO.	REVNO.	REVISIONS	DATE	BY	CHKD APPR
8	CONFIDENTIALITY NOTICE THIS DRAWING AND INFORMATION CONTAINED HEREIN ARE THE EXCLUSIVE PROPERTY OF EMERSON CLIMATE TECHNOLOGIES, INC. AND SHALL BE RETURNED UPON DEMAND AND SHALL NOT BE REPRODUCED IN WHOLE OR IN PART TO ANYONE ELSE OR USED, WITHOUT THE WRITTEN CONSENT OF EMERSON CLIMATE TECHNOLOGIES, INC.				
MATERIAL SPECIFICATION		DRAWN BY VDK	SUPERSEDES DWG. NO. / REV. NO. 003-1185-00 / 2		
VALOX DR-48		DATE 01-28-09	SCALE 1:1	DATE FORMAT: MM-DD-YY	
TITLE	PLATE-ADAPTOR		DRAWING NUMBER SHEET 1 OF 1 003-1185-00		

UNCONTROLLED COPY - DO NOT MODIFY